

Matchline SEE SHEET LP-4

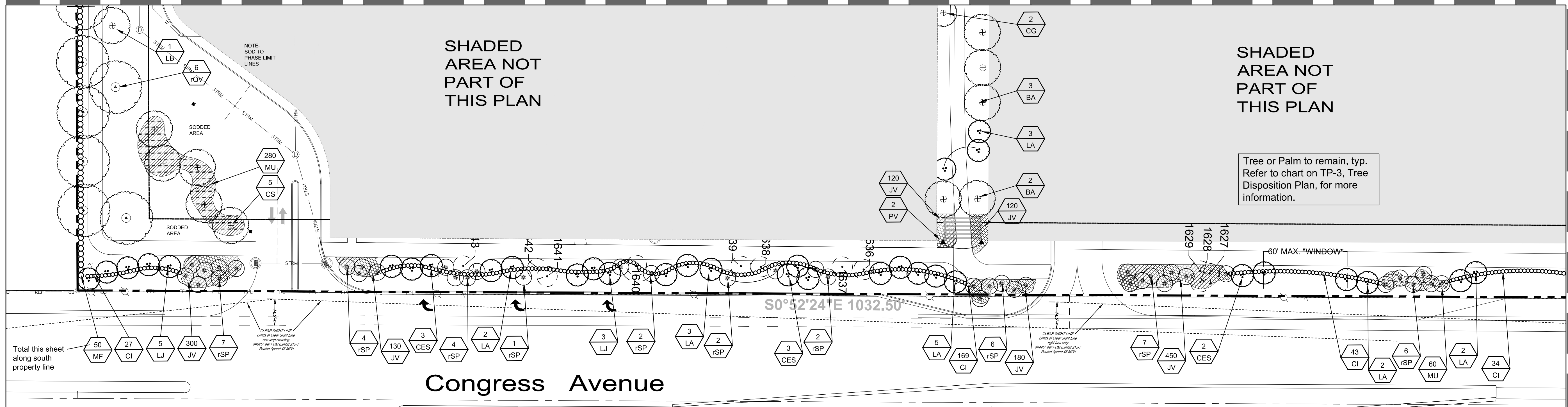

Matchline

SEE SHEET LP-7

See LP-6 for Plant Key & Replacement Tabulations
See LP-8 for Standard Planting Details & Notes

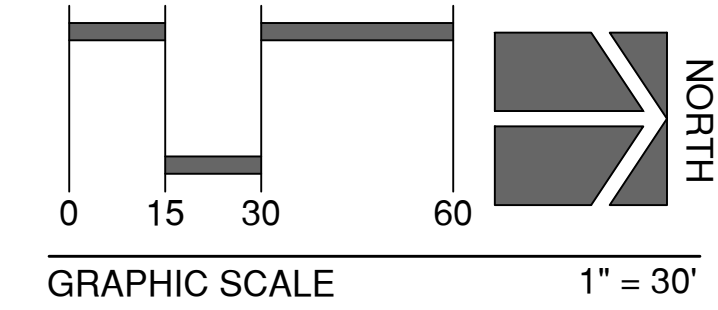

PLANT KEY

Quantity	Plan Symbol	Botanic Name / Common Name Specification	Degree of Drought Tolerance	Tree/Palm Replacement 1:1	Tree d.b.h. Replacement
135	AZ	Alpinia zerumbet 'Variegata' / Variegated Shell Ginger 24" o.a., full, 24" o.c.	VERY		
18	BA	Bulnesia arborea / Verawood 24" ht. x 8' spr., 4" d.b.h., balanced branching, 5' c.t.	VERY		18 @ 4" 72"
43	CA	Crinum procerum splendens / Queen Emma Lily 30" ht.	VERY		
39	CE*	Cococarpus Erectus / Green Buttonwood 16' ht. x 8' spr., 4" d.b.h., balanced branching, 5' c.t.	VERY		39 @ 4" 156"
25	CES*	Cococarpus erectus sericeus / Silver Buttonwood 12' ht. x 6' spr., 5' c.t., multi-stem tree form	VERY	25	
10	CG	Caesalpinia granadillo / Bridalveil Tree 12' ht. x 6' spr., 5' c.t.	MOD	10	
5	CS	Chorisia speciosa 'Monza' / Thornless Floss Silk Tree 16' ht. x 8' spr., 8" d.b.h., balanced branching, 5' c.t.	VERY	4	1 @ 5" 5"
500	CU	Coccoloba uvifera / Seagrape 36" ht. x 24" spr., 30" o.c., full to ground	VERY		
2250	CI*	Chrysobalanus Icaco "Red Tip" / Red Tip Cocoplum 24" ht. x 15" spr., 24" o.c.	VERY		
14	DR	Delonix regia / Royal Poinciana 18-20' x 10' spr., 6" d.b.h., balanced branching, 6' c.t.	VERY		14 x 6" 84"
800	ES	Euphorbia milii "Short & Sweet" / Thornless Crown of Thorns 10" o.a., 12" o.c., pink	VERY		
2562	FM	Ficus microcarpa 'Green Island' / Green Island Ficus 12" ht. x 15-18" spr., maintain at 24" ht.	-		
750	IV*	Ilex Vomitoria 'Shellings Dwarf' / Dwarf Yaupon Holly 10-12" ht. x 15" spr., 15" o.c.	VERY		
6295	JV	Jaminum volubile / Wax Jasmine 10-12" ht. x 15" spr., 15" o.c.	VERY		
35	LA	Lagerstroemia indica 'Muskogee' / Pink Crape Myrtle 16' ht. x 6.5' spr., 4" d.b.h., 5' c.t. standard	VERY	25	10 x 4" 40"
11	LB*	Lysiloma Bahamiensis / Wild Tamarind 16' ht. x 8' spr., 4" d.b.h., 5' c.t., balanced branching	VERY		11 x 4" 44"
29	LJ	Ligustrum Japonicum / Japanese Privet 12' ht. x 6' spr., 5' c.t., multi-stem tree form	VERY	29	

PLANT KEY (cont.)

Quantity	Plan Symbol	Botanic Name / Common Name Specification	Degree of Drought Tolerance	Tree/Palm Replacement	Tree d.b.h. Replacement
403	MF*	Myrcianthes Fragrans / Simpson Stopper 30" ht. x 20-24" spr., 30" o.c.	VERY		
1515	MU*	Muhlenbergia capillaris / Pink Muhly Grass 24" ht. x 18" spr., 24" o.c.	VERY		
175	PS	Philodendron selloum / Selloum 24" ht., min. 2 heads per pot, 30" o.c.	VERY		
4	PV	Petrea volubilis / Queen's Wreath 36" ht., min. 3 main runners, train to arbor with plastic ties	VERY		
8	QV*	Quercus Virginiana / 'Highrise' Live Oak 16' ht. x 8' spr., 4" d.b.h., 5' c.t.	VERY	8	
25	QVH*	Quercus Virginiana 'Highrise' / 'Highrise' Live Oak 16' ht. x 8' spr., 4" d.b.h., 5' c.t.	VERY		25 @ 4" 100"
24	RE	Roystonea Elata / Royal Palm g.w. ht. as noted on plan, heavy trunk, matched	VERY	24 palms	
200	SA	Schefflera Arboricola 'Trinette' / Dwarf Var. Schefflera 18" ht. x 12" spr., 24" o.c.	VERY		
22	SG*	Simarouba glauca / Paradise Tree 16' ht. x 8' spr., 4" d.b.h., balanced branching, 5' c.t.	VERY	22	
59	SP*	Sabal palmetto / Cabbage Palm Stagger c.t. hts. 14-20' in ea. group per detail on LP-8	VERY	59 palms	
19	TC	Tabebuia caraiba / Yellow Trumpet Tree 16' ht. x 8' spr., 4" d.b.h., balanced branching	VERY	19	

Trees & Palms to be Relocated

71	rQV*	Quercus Virginiana / Live Oak Relocated from site. Note oaks to be relocated with 18" and larger trunks are noted by tree # per the Tree Disposition Plan and are to be relocated to park area as shown on LP-3 & 5.	VERY		
58	rSP*	Sabal palmetto / Cabbage Palm Relocated from site. Stagger c.t. hts. 14-20' in ea. group per detail on LP-8	VERY		

Removal & Replacement

SEE ALSO TREE DISPOSITION PLAN

Trees & Palms to Remain - 123
(primarily located in future perimeter buffer area)

Trees & Palms to be Relocated - 129
(rated quality at least 40% by LeGette report and located in developable area)

Trees - 71 (all live oaks) THIS PLAN - 71 LIVE OAKS RELOCATION SHOWN
Palms - 58 (all cabbage palms) - THIS PLAN 58 CABBAGE PALMS RELOCATION SHOWN

Trees & Palms to Remove - 364
(located in total site, due to rating in report)

Trees
Rating Quant.
0-49% 176 @ 1:1 Trees
50-100% 31 Total dbh = 501"
Total - 207

THIS PLAN 142 @ 1:1 REPLACEMENT TREES
34 TREES TO BE REPLACED IN FUTURE PHASE
THIS PLAN 501" REPLACEMENT

Palms
Rating Quant.
0-49% 142
50-100% 15 (up to 60' ht.)
Total - 157

THIS PLAN 83 REPLACEMENT PALMS
74 PALMS TO BE REPLACED IN FUTURE PHASE

TOTAL TREES & PALMS ORIGINALLY ON SITE - 616

All sod shall be St. Augustine "Floratam"

NOTE - THE CONTRACTOR IS RESPONSIBLE TO VERIFY ALL QUANTITIES AND REPORT ANY DISCREPANCIES TO THE LANDSCAPE ARCHITECT.
* = Florida Native
Drought tolerance noted is per SFWMD (May 2003) "Waterwise", South Florida Edition or University of Florida IFAS Extension Service

Abbreviations:
c.w. - clear wood o.a. - overall
g.w. - grey wood o.c. - on-center spacing
ht. - height spr. - spread

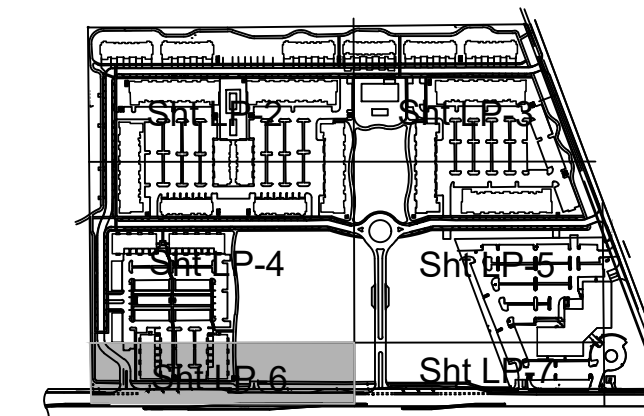

Sheet Key
N.T.S.

Covelli Design Associates Inc.
2295 NW Corporate Blvd., Suite 213
Boca Raton, Florida 33431
561-910-0330
LC 26000287
covellidesign.com
Urban Planning • Landscape Architecture

Landscape Plan
1690-2350 South Congress Avenue
Delray Beach Florida

Date	09-04-2018
Scale	As Noted
PN#	1231

PREPARED BY
Steven E. Tate, R.L.A.
Landscape Architect #967
State of Florida
For The Firm
DATE 09-10-2018

Drawing No.
LP-6
OF 8

