



CITY OF DELRAY BEACH

CITY MANAGER'S OFFICE

100 N.W. 1ST AVENUE • DELRAY BEACH • FLORIDA 33444 • (561) 243-7015



City Commission Information Letter

November 5, 2021

Follow-Up Response and Direction Regarding PFAS

Both the Office of the City Manager and that of Director of Utilities Hassan Hadjimiry are pleased to report that the City of Delray Beach and the Florida Department of Health have reached a mutual understanding relative to PFAS monitoring activities.

As referenced in the attached response letter to Florida Department of Health Environmental Administrator Jorge R. Patino, guidance to this effect involves continued testing of PFAS levels respectively on a quarterly basis.

As we've recently reported, the City of Delray Beach's drinking water consistently has PFAS levels below the Environmental Protection Agency's health advisory level threshold of 70 nanograms per liter. Staff involved in this process were more than supportive of the direction as outlined and are committed to continuing to ensure that the City's drinking water meets all environmental and regulatory standards consistent with the tenants of the Safe Drinking Water Act.

We will therefore disseminate information to this effect as a function of our continued educational outreach efforts. Meanwhile, much appreciation to the leadership and staff of the Department of Utilities for excellent progress and achievement as noted.

Considerations to Support Utility Rate Structure

My office recently hosted a meeting with the City's utility analysis consultant, Willdan Financial Services, to establish recommendations to support the implementation of various capital improvement projects and to ensure a long-term, healthy enterprise fund operation. Willdan Financial Services was

City Commission Information Letter

November 5, 2021

Page 2

commissioned earlier this year to assist staff and administration with the review and evaluation of the current utility rate structure.

The future water treatment plant facility will feature enhancements relative to water quality standards, including the application of membrane softening and other applicable technology. In addition to the considerations as noted, significant dialogue will take place concerning the marketplace relative to rates vis-à-vis other municipalities, rising operational expenses, and increasing personnel costs, and will be the basis to offer a comprehensive financial plan for City Commission review and consideration. Arrangements are therefore being made to prepare for a workshop meeting in January.

Meanwhile, all involved in this endeavor, including leadership in the Department of Utilities and the Department of Finance, will engage with the City's External Financial Advisor, Mr. Jay Glover, to ensure the team is productive and well prepared.

Considerations Regarding Restoration of Natural Tree Habitat and Canopy Coverage

In response to a myriad of discussions and observations I've experienced relative to tree habitat protection and applicable canopy coverage in various areas of Delray Beach, I've asked various members of the Executive Leadership Team with background, experience, and expertise on the subject to help orient me relative to issues and concerns regarding invasive species in the community. The initial genesis of this review involved observations concerning Australian Pines located at Atlantic Dunes Park, and some level of interest to consider a protection initiative as noted.

As the City of Delray Beach has supported a long-standing ordinance prohibiting certain plant species such as Melaleuca, Brazilian Pepper, Australian Pine, Carrotwood, and other invasive tree varieties, direction is currently being offered to implement healthy tree canopy programs throughout Delray Beach. Guidance

City Commission Information Letter

November 5, 2021

Page 3

to this effect will conform to standards, practices, and principles endorsed by both Tree City U.S.A. and Blue Flag Beach (an international designation established to recognize healthy beach environments).

As the City of Delray Beach is currently pursuing a designation from Blue Flag Beach as noted, an opportunity for ancillary public clarification on the subject will be offered during the December 14th meeting, via a presentation summarizing the content of the Blue Flag Beach application. Meanwhile, leadership in both Public Works and Development Services were industrious enough to compile the attached background information to help illustrate the rationale for the current situation accordingly.

Process to Support Administration of Privately Initiated Amendments to Land Development Regulations

Given the recently adopted ordinance to support land development regulation (LDR) amendments that require an elected official's sponsorship to submit applications for both processing and public consideration, both the Department of Development Services and the Office of the City Attorney have developed a quarterly workshop schedule to help facilitate reviews of such requests.

As noted in the November 9th workshop meeting agenda, the first opportunity to proceed as outlined involves an LDR amendment request to consider adding the use of golf carts for tours in the central business district. Likewise, direction is concurrently being offered to schedule future amendment proposal considerations via the quarterly schedule process, as individuals and/or groups interested in pursuing changes to the LDR will be formally advised in advance accordingly.

Calendar of Activities, Meetings and Functions

Both Mayor Petrolia and I, along with Mr. Todd L'Herrou of Sister Cities International, all had an enjoyable experience this past Wednesday relative to

SERVICE · **P**ERFORMANCE · **I**NTEGRITY · **R**ESPONSIBLE · **I**NNOVATIVE · **T**EAMWORK

City Commission Information Letter

November 5, 2021

Page 4

diplomatic relations here in Delray Beach, as we hosted a meeting and luncheon with Mr. Kazuhio Nakai, Consul General of Japan.

This exercise resulted in a reemphasis dialogue relative to the significance of Japanese culture in our community, as well as discussions concerning mutual observations of the current state of affairs internationally. We were proud to showcase Delray Beach's central business district, as well as to share immediate plans and vision relative to continued growth and prosperity.

With next business week being abbreviated due to the Veterans Day holiday, no information letter will be issued Friday, November 12th. However, as I've recently concluded my first three months of service as Delray Beach City Manager, an ancillary report titled "First 90 Days of Service" will be distributed that day.

In addition to a condensed summary of achievements and contributions offered by the Office of the City Manager during this timeframe, I will also provide an introductory message that briefly outlines observations to date in Delray Beach in relationship to previous leadership background. I therefore sincerely hope that this report will be valued and appreciated by all who are interested and concerned accordingly.

Enclosures:

Response Letter to Jorge R. Patino, P.E., Florida Department of Health, Palm Beach County – Water Treatment Plant
Boundary Map – Atlantic Dunes Park (East Side) Plans
Background Summary Lists and Photos – Direction for Natural Habitat and Canopy Coverage
Electronic Mail Message from Lynn Gelin – Sponsorship of Privately Initiated Text Amendments
Calendar for Business Week of November 1, 2021

CM/Documents/City Commission Information Letter 11



CITY OF DELRAY BEACH

UTILITIES DEPARTMENT

434 S. SWINTON AVE • DELRAY BEACH • FLORIDA 33444 • (561) 243-7000



November 02, 2021

Jorge R. Patino, P.E.
Environmental Administrator, Water Programs
Division of Environmental Public Health
Florida Department of Health, Palm Beach County
800 Clematis Street
West Palm Beach, Florida 33401

Re: City of Delray Beach Water Treatment Plant
PWS #4500351, PFAS Detections

Dear Mr. Patino,

Thank you for your letter on October 13, 2021, regarding the Per- and Polyfluoroalkyl Substances (PFAS) testing which Delray Beach Utilities has been conducting.

Delray Beach Utilities is in the early planning stages of a new membrane softening (nano filtration) water treatment plant. This kind of water treatment plant will provide our customers with many benefits, including the reduction of PFAS levels.

As mentioned in previous written communications, the PFAS levels at the Point of Entry (POE) have been consistently below the health advisory level of 70 ng/L.

In our continued partnership with the Florida Department of Health (FDOH) and in keeping with our commitment to reassurance our residents that Delray Beach's drinking water meets or exceeds all the standards set by regulatory agencies, we accept your recommendation to continue PFAS testing at POE on a quarterly basis for two additional years.

Over the past year the City of Delray Beach has performed PFAS testing that the Environmental Protection Agency, Florida Department of Environmental Protection and Florida Department of Health have yet to put in place for all cities in our area. In the coming years, as these agencies work to establish PFAS regulations, we look forward to continuing our city's commitment to quality and transparency.

If you have any further questions or require additional information, please do not hesitate to contact this office at (561) 243-7303.

Sincerely,

Hassan Hadjimiry

Hassan Hadjimiry, P.E., Utilities Director

C: Terrence R. Moore, ICMA-CM, City Manager
Lynn Gelin, Esq., City Attorney
Gina Carter, Communication Director

SERVICE • **P**ERFORMANCE • **I**NTEGRITY • **R**ESPONSIBLE • **I**NNOVATIVE • **T**EAMWORK

Atlantic Dunes Park (East Side) Plans:

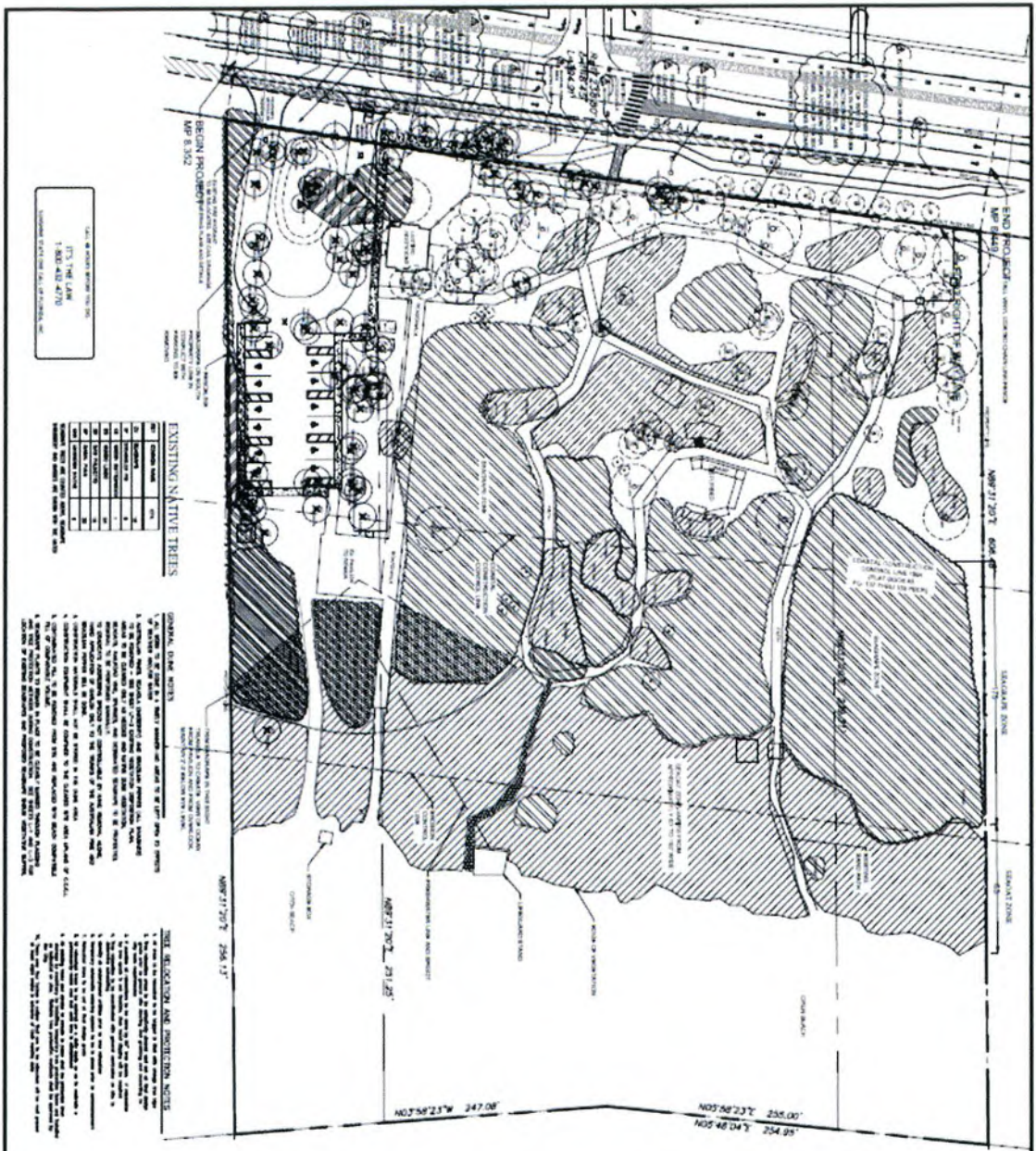

EXISTING NATIVE TREES

ID	COMMON NAME	HT	DBH	STATUS
1	FLORIDA PALM	10	12	PROTECT
2	FLORIDA PALM	10	12	PROTECT
3	FLORIDA PALM	10	12	PROTECT
4	FLORIDA PALM	10	12	PROTECT
5	FLORIDA PALM	10	12	PROTECT
6	FLORIDA PALM	10	12	PROTECT
7	FLORIDA PALM	10	12	PROTECT
8	FLORIDA PALM	10	12	PROTECT
9	FLORIDA PALM	10	12	PROTECT
10	FLORIDA PALM	10	12	PROTECT

GENERAL NOTES:

1. ALL TREES TO BE PROTECTED AND MAINTAINED THROUGHOUT THE PROJECT.
2. ALL TREES TO BE PROTECTED AND MAINTAINED THROUGHOUT THE PROJECT.
3. ALL TREES TO BE PROTECTED AND MAINTAINED THROUGHOUT THE PROJECT.
4. ALL TREES TO BE PROTECTED AND MAINTAINED THROUGHOUT THE PROJECT.
5. ALL TREES TO BE PROTECTED AND MAINTAINED THROUGHOUT THE PROJECT.
6. ALL TREES TO BE PROTECTED AND MAINTAINED THROUGHOUT THE PROJECT.
7. ALL TREES TO BE PROTECTED AND MAINTAINED THROUGHOUT THE PROJECT.
8. ALL TREES TO BE PROTECTED AND MAINTAINED THROUGHOUT THE PROJECT.
9. ALL TREES TO BE PROTECTED AND MAINTAINED THROUGHOUT THE PROJECT.
10. ALL TREES TO BE PROTECTED AND MAINTAINED THROUGHOUT THE PROJECT.

SEE DETAIL AND PROTECTION NOTES:

1. SEE DETAIL AND PROTECTION NOTES.
2. SEE DETAIL AND PROTECTION NOTES.
3. SEE DETAIL AND PROTECTION NOTES.
4. SEE DETAIL AND PROTECTION NOTES.
5. SEE DETAIL AND PROTECTION NOTES.
6. SEE DETAIL AND PROTECTION NOTES.
7. SEE DETAIL AND PROTECTION NOTES.
8. SEE DETAIL AND PROTECTION NOTES.
9. SEE DETAIL AND PROTECTION NOTES.
10. SEE DETAIL AND PROTECTION NOTES.

LOCATION

PROTECTION DETAIL

LEGEND

- EXISTING NATIVE TREES
- CONSERVATION SENSITIVE AREAS
- PROTECTION DETAIL
- NO TREE LEGEND
- NO VEGETATION KEY

SCALE 1"=40'

ATLANTIC DUNES PARK DELRAY BEACH, FL	EXISTING VEGETATION DISTRIBUTION PLAN	LAND LANDSCAPE ARCHITECTURE	
--	---	---------------------------------------	--

Park Plans include:

- **Access improvements** – Improved entrance area that allows for dropoff area and improved sight distance upon departure
- **ADA Accessibility improvements** – Increased number of handicap parking spaces, barrier-free play area, boardwalks on many trails
- **Restoration** – Restore Southeast Florida Coastal Strand and Maritime Hammock habitat, removal of invasive species
- **Environmental Education** – Outdoor classroom, educational signage

Other benefits:

Restoration of native habitat and environmental education components support the City of Delray Beach application for Blue Flag Beach status.

Project cost:

Approximately \$2 million

Permitting / Landscape agreement with FDOT:

FDEP – Pending

FDOT/MMOA -- Complete

Public Outreach:

Not started

Current Status:

Plans are complete

Atlantic Dunes Park -- Southeast Florida Coastal Strand and Maritime Hammock



Maritime Hammock Park, Melbourne



Cumberland Gap, Georgia

Summary:

This ecological system occurs as a narrow band of hardwood forest and shrublands along the Atlantic Coast of southeastern Florida (approximately Volusia County

southward). It is found on stabilized, old, coastal dunes, often with substantial shell components. The vegetation is characterized by hardwood species with tropical affinities. As such, the northern extent of this type is limited by periodic freezes. This system is closely related to both inland tropical hammocks and southwest Florida maritime hammocks, and may share some species overlap with each. Atlantic Dunes Park is an example of a remnant of the Southeast Florida Coastal Strand and Maritime Hammock habitat.

Dynamics:

The northern extent of this type is limited by periodic freezes and lack of cold tolerance of tropical plants, such as *Guapira discolor* and *Exothea paniculata* (Johnson and Muller 1993a). Maritime hammocks are relatively stable forest communities, as long as the canopy remains intact and the underlying landform is stable (FNAI 1990).

Threats and Other Change Agents:

Coastal development has been and remains a big threat to this vegetation. Fragmentation of remaining areas is also a threat. Invasion by exotic plants following natural disturbance (such as hurricanes) is an ongoing threat (Johnson 1994b, FNAI 2010a). *Casuarina equisetifolia*, common name Australian pine, is the biggest invasive exotic plant threat. Due to its competitive abilities, *Casuarina equisetifolia* can completely replace the native plant species in recolonizing coastal strand after storms or as beaches build out after natural coastal disturbances (Johnson 1994b).

Historic Plant Communities:

Anecdotal information provided by local scientists and native plant experts indicate that the Atlantic Dunes Park tree canopy was predominantly characterized by tropical tree species such as Gumbo Limbo, Spanish Stopper, and large seagrape trees, along with a smaller number of live oak trees. The understory was characterized by saw palmetto in areas where seagrape was not dominant.

Terrence R. Moore

From: Gianniotis, Anthea
Sent: Wednesday, November 3, 2021 4:21 PM
To: Barletto, Missie; Terrence R. Moore; Metott, Samuel
Subject: RE: Atlantic Dunes Park documents

LDR Section 4.6.16(G)

G) *Prohibited and controlled species.*

(1) **Prohibited plant species.** All prohibited plant species shall be eradicated from the development site and reestablishment of prohibited species shall not be permitted. The following plant species shall not be planted in the City of Delray Beach:

- (a) Melaleuca quinquenervia (commonly known as Punk tree, paper bark, Cajeput, Melaleuca); or
- (b) Schinus terebinthifolius (commonly known as Brazilian Pepper or Florida Holly); or
- (c) Casuarina Species (commonly known as Australian Pine); or

Anthea Gianniotis, AICP
Development Services Director
561-243-7041 | 100 N.W. 1st Avenue, Delray Beach, Florida 33444

From: Barletto, Missie <BarlettoM@mydelraybeach.com>
Sent: Wednesday, November 3, 2021 4:01 PM
To: Terrence R. Moore <moore@mydelraybeach.com>; Gianniotis, Anthea <GianniotisA@mydelraybeach.com>; Metott, Samuel <MetottS@mydelraybeach.com>
Subject: Atlantic Dunes Park documents

Please see attached ... Missie

Missie Barletto | Public Works Director
☎ 561-243-7000 ext. 4104 | ☎ 239-707-2371 | ✉ barlettom@mydelraybeach.com | 434 South Swinton Avenue, Delray Beach, Florida 33444



CITY OF DELRAY BEACH

Terrence R. Moore

From: Gelin, Lynn
Sent: Tuesday, October 19, 2021 5:34 PM
To: Terrence R. Moore
Cc: Johnson, Katerri; Gianniotas, Anthea
Subject: Sponsorship of Privately Initiated Text Amendments

Mr. Moore: I would propose that the City create a quarterly workshop schedule specific to privately initiated text amendments in order for these requests to be presented to the City Commission for their consideration and possible sponsorship in a timely manner. I propose the following dates:

November 9th workshop
January 11th
April TBD
July TBD
October TBD

By having a quarterly schedule, when requests are made, staff could apprise the applicant of the available dates. Depending on how many items are scheduled for a workshop, I would propose no more than 3 per workshop date.

Lynn Gelin, Esq.
City Attorney

200 N.W. 1st Avenue
Delray Beach, FL 33444
561.243.7090

PUBLIC RECORDS NOTE: Florida has a very broad public records law. Most written communications to or from local officials, employees, or the general public regarding city business are public records available to the public and media upon request. Your e-mail communication may therefore be subject to public disclosure.

November 1, 2021 - November 7, 2021

November 2021						
Su	Mo	Tu	We	Th	Fr	Sa
		1	2	3	4	5
7	8	9	10	11	12	13
14	15	16	17	18	19	20
21	22	23	24	25	26	27
28	29	30				

December 2021						
Su	Mo	Tu	We	Th	Fr	Sa
			1	2	3	4
5	6	7	8	9	10	11
12	13	14	15	16	17	18
19	20	21	22	23	24	25
26	27	28	29	30	31	

Monday, November 1

- 8:30am - 8:40am New employee orientation (First Floor Conference Room) - Bast, Dot ☺
- 9:00am - 10:00am Direction Concerning Freebee Program Administration (Delray Beach City Hall Office of the City Manager) -
- 10:00am - 11:30am Mayor mtg w/CM Moore Re: Agenda & Updates (Commission Chambers) - Rangel, Delores ☺
- 11:00am - 12:00pm Mayor mtg w/CM, CA & Hassan Hadjimiry Re: Utilities Discussion (City Manager's Conference Room) - Rangel,
- 12:00pm - 1:00pm Keith Utsey (TBD) - Terrence R. Moore
- 2:00pm - 3:00pm Begin CIL (CM Office)
- 3:00pm - 4:00pm VM Johnson Mtg w/CM Moore Re: Agenda & Updates (City Manager's Office) - Rangel, Delores ☺
- 4:00pm - 5:00pm VM Johnson mtg w/CM, CA & Hassan Hadjimiry Re: Utilities Discussion (Commission Conference Room) - Rangel,
- 4:30pm - 5:00pm Considerations Regarding Australian Pines

Tuesday, November 2

- 8:30am - 9:30am Scope and Focus for Pending Classification and Compensation Study (CM Office) - Terrence R. Moore
- 10:00am - 11:00am NAPA Integrated Business Solutions (City Manager's Office 100 NW 1st Avenue, Delray Beach, FL 33444) - Vega, Brenda
- 11:00am - 12:00pm Compile Information Letter Report - Follow-Up Response and Direction Concerning PFAS (CM Office) - Terrence R. Moore
- 12:00pm - 1:30pm Various (Various)
- 2:00pm - 3:00pm A. Gray and B. Jones (CM Office)
- 4:00pm - 8:00pm November 2nd Regular Commission Meeting - Viewing of Presentations (Microsoft Teams Meeting) - Harris, Patrice
- 4:00pm - 6:30pm City Commission Regular Meeting ☺

Wednesday, November 3

- 8:00am - 9:00am COVID-19 Protocols (City Manager's Office) - Vega, Brenda
- 9:00am - 11:00am Executive Leadership Team Meeting (Conference Room - Commission Chambers) - Vega, Brenda ☺
- 9:00am - 10:00am Agenda Review Meeting (November 16th CC Meeting) (Commission Chambers) - Conference Room - Commission Chambers
- 11:00am - 2:00pm Visit from Consul General of Japan Mr. Nakai
- 2:00pm - 2:30pm Bank of America (Bank of America)
- 3:00pm - 4:00pm Review and Analysis of Certification Considerations Regarding Building Construction (Conference Room - City Manager) - Vega, Brenda
- 4:30pm - 5:30pm Compile Information Letter Report - Considerations Regarding Australian Pines Regulations (TITLE) (CM Office) - Terrence R. Moore

Thursday, November 4

- Delores ooo
- 8:00am - 9:00am Compile Information Letter Report - Considerations to Support Utilities Rate Structure (CM Office) - Terrence R. Moore
- 9:00am - 10:00am Follow-Up Meeting with Paula Rocker (Microsoft Teams Meeting) - Vega, Brenda
- 10:00am - 11:00am Gregory Gabriel, Ocean Capital Real Estate Services Group re: Introduction and Real Estate Developments (City
- 11:30am - 12:30pm Compile Information Letter Report - Process to Support Sponsorship of Privately Initiated Text Amendments
- 2:00pm - 3:30pm Various (Various) ☺
- 2:00pm - 2:30pm DVM Frankel mtg w/CM, CA & Hassan Re: Utilities discussion (City Manager's Conference Room) - Rangel,
- 4:00pm - 4:30pm Florida Heat Youth Foundation Site Visit (313 NE 3rd Street) - Vega, Brenda

Friday, November 5

- Janet ooo
- Live Burn 408 SE 2nd Street
- 7:30am - 9:00am Finalize CIL (CM Office) ☺
- 9:00am - 10:00am Meeting with Beach Keepers Inc. (City Manager's Office) - Vega, Brenda
- 10:00am - 11:00am CITY OF DELRAY BEACH > Tourism Master Plan - Task Force Kick Off Meeting
- 10:00am - 11:00am DB TOURISM MASTER PLAN > Task Force Kickoff Meeting (HOLD THE DATE) (ZOOM meeting link to by issued
- 11:00am - 11:30am Moving Expense Payments/Contract Terms for New Hires (City Manager's Office) - Vega, Brenda
- 12:00pm - 1:00pm Tentative - Heart of the Square Exhibition
- 2:00pm - 2:30pm Comm. Casale mtg w/CM, CA & Hassan Re:
- 2:30pm - 3:00pm Comm. Casale Mtg w/CM Moore Re: Bi-Weekly
- 4:30pm - 5:30pm Jabari Hopkins re: ICMA Mentorship (City of

Saturday, November 6

- 8:00am - 8:30am Tennis Machine Transaction (Home)
- 10:00am - 11:00am Delray Beach Tennis Center (Hard Court #1) ☺
- 12:00pm - 2:00pm Various (CM Office)
- 1:00pm - 1:30pm MB (City Hall) (City Hall) - Terrence R. Moore

Sunday, November 7